



# REVOCABLE LIVING TRUST

This Revocable Living Trust was executed on \_\_\_\_\_ between the following parties:

**GRANTOR**

**TRUSTEE**

## I. TRUST NAME

A. This Trust will be named \_\_\_\_\_.

## II. PURPOSE

A. The Purpose and reason of this trust are to make sure that the assets and property will be maintained, managed, and controlled.

B. It also protects the assets and the properties.

## III. REVOCATION

A. The Grantor has the right to change or revoke this Trust with no given specific time as long as he/she is alive.

B. When the Grantor dies, this Trust is considered irrevocable which means it cannot be changed or amended.

## IV. TRUSTEE DETAILS

A. In this Trust, the initial trustee will be \_\_\_\_\_.

B. Here are the details about the initial trustee:

# REVOCABLE LIVING TRUST

---

- C. The backup successor will be \_\_\_\_\_.
  - D. The Trustee \_\_\_\_\_ for the provided services.
  - E. If the Trustee will receive compensation, it will \$\_\_\_\_\_.
- 

## V. TRUSTEE'S RESPONSIBILITIES

---

## VI. CHANGING TRUSTEE

A. The Grantor have the right to remove and update the Trustee as long as a written document is signed indicating that Trustee will be remove or updated.

---

## VII. GRANTOR'S LIFETIME

A. The Trustee can distribute any amount to the Grantor provided that he or she is not incapacitated.

B. If incapacitated, a reasonable amount will be provided by the Trustee instead.

---

## VIII. GRANTOR'S DEATH

A. All obligations and debts will be paid first before distributing the Trust Property which is indicated on a separate document that determines which properties go to who and when.

# REVOCABLE LIVING TRUST

---

## IX. SUBTRUST

A. The Grantor \_\_\_\_\_.

B. If Grantor has children, here are the details:

C. The Subtrust will be \_\_\_\_\_.

D. He/She will be Subtrust once he or she reached the age of \_\_\_\_\_.

---

## X. PETS

A. The Grantor \_\_\_\_\_.

B. If there is, then an amount of \$\_\_\_\_\_ will be used for the care of the pet.

---

## XI. TIME IS OF THE ESSENCE

A. The roles and responsibilities of the involved parties in Trust are a time of the essence. Schedules and meetings must be followed strictly followed and extensions without valid reasons.

---

## XII. CONFIDENTIALITY

This Trust will make sure that all information in this document is strictly confidential. All information shared here between the parties are confidential.

---

# REVOCABLE LIVING TRUST

## XIII. GOVERNING LAW

This Trust shall be governed under the laws of \_\_\_\_\_,  
\_\_\_\_\_.

---

## XIV. SIGNATURE

We, the undersigned, hereby agreed that we have read this agreement and bounded by its terms and conditions.

**Grantor's Signature**

**Trustee's Signature**

\_\_\_\_\_

\_\_\_\_\_

**Date Signed**

**Date Signed**

---

Property Details attached below:

	Property Name	Property Description	Notes
1			
2			
3			
4			
5			



Thanks for using **Revocable Living Trust!** To edit this PDF with **Jotform Sign**, sign up for a free Jotform account today.

[EDIT PDF](#)

## Learn More About Jotform PDF Products

Jotform offers powerful PDF solutions. Check them out below.

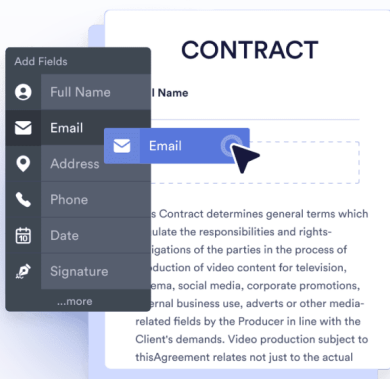

### JOTFORM PDF EDITOR

Turn form submissions into PDFs automatically — ready to download or save for your records.

[Go to PDF Editor >](#)

### SMART PDF FORMS

Convert your PDF files into online forms that are easy to fill out on any device.

[Go to Smart PDF Forms >](#)

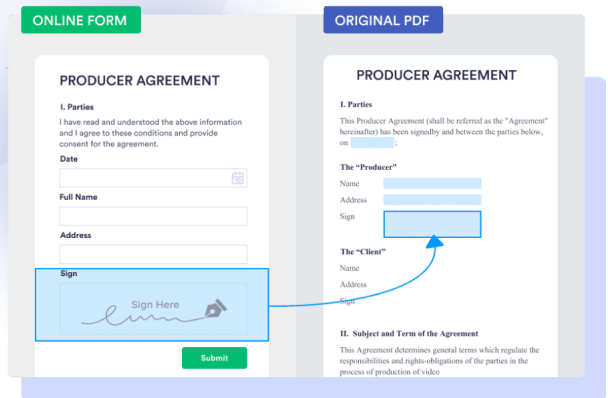

### JOTFORM SIGN

Collect e-signatures with Jotform Sign to automate your signing process.

[Go to Jotform Sign >](#)

*These templates are suggested forms only. If you're using a form as a contract, or to gather personal (or personal health) info, or for some other purpose with legal implications, we recommend that you do your homework to ensure you are complying with applicable laws and that you consult an attorney before relying on any particular form.*